



Submersible Dewatering Pump

KBZ

- The body of motor and pump is made of rigid cast iron for lasting durability.
- Greatly increased maximum submersion depth due to mechanical seal resistant to high pressure (0.5Mpa)
- Semi-open impeller made of high chrome alloy match with were plate (ductile iron) achieves superior durability.
- Effective motor cooling due to discharge channel case as part of the motor housing. Space economy bya top outlet.
- Discharge 50mm (2") to 150mm(6"), Motor 1.5KW (2HP) to 15KW(20HP)
- Hermetically sealed motor equipped build-in thermal protection.

Application

- Civil engineering, Building sites, Basements or utility pits; Sewage treatment plants; General pumping purposes.
- Pumping fluid: Rainwater, Mud water and Fluid with high abrasive

Specifications:

- Capacity: up to 147m³/h
- Head: up to 51 meters
- Power: 1.5KW (2HP) to 11KW (15HP)
- Power Supply: 3 ph / 380V±10% / 50Hz;60Hz
- Insulation class: F
- Protection class: IP68
- Cable Length: 8 meters
- Water temperature: up to 40°C
- Max. water depth: 50 meters



Model	d	A	A1	B	D	H	W1
KBZ21.5	50	235	173	517	216	486	120
KBZ22.2	50	235	173	517	216	486	120
KBZ23.7	50	283	208	628	252	638	150
KBZ31.5	80	235	173	517	216	486	120
KBZ32.2	80	235	173	517	216	486	120
KBZ33.7	80	283	208	628	252	638	150
KBZ35.5	80	306	218	671	259	688	150
KBZ43.7	100	283	208	642	252	638	150
KBZ45.5	100	306	218	686	259	688	150
KBZ47.5	100	330	240	764	314	676	190
KBZ411	100	373	255	807	350	695	190
KBZ415	100	373	255	842	350	755	190
KBZ67.5	150	330	240	790	314	676	190
KBZ611	150	373	255	807	350	695	190
KBZ615	150	373	255	842	350	755	190

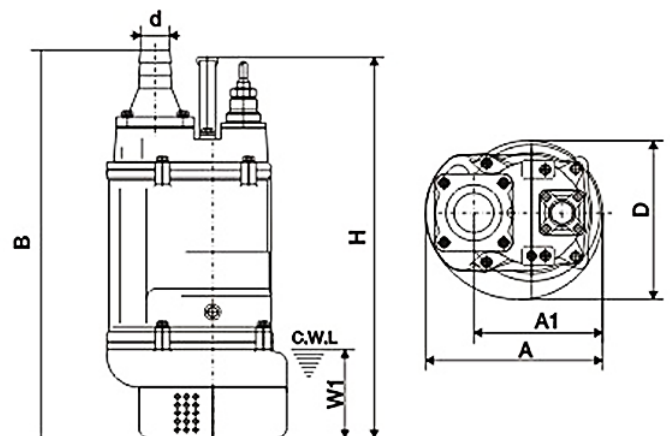



Submersible Dewatering Pump

KBZ

Performance Curves:

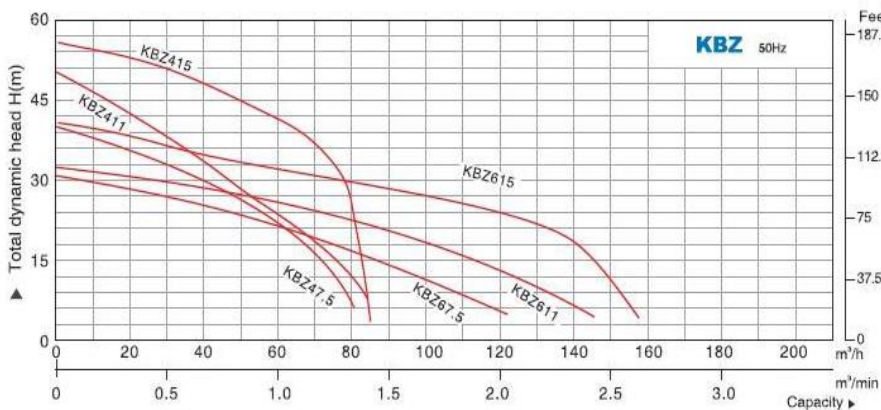
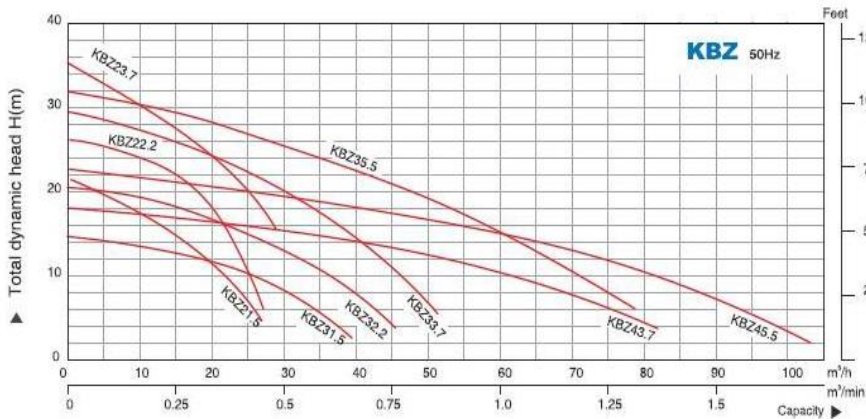

Materials of Construction:

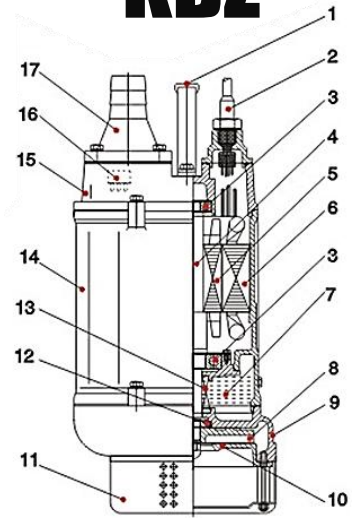

No.	Part Name	Material
1.	Handle	Rubber & Steel
2.	Cable	2PNCT-F
3.	Bearing	Ball bearing
4.	Shaft	AISI420SS
5.	Rotor	/
6.	Stator	/
7.	Lube Oil	/
8.	Impeller	High chrome alloy or ductile iron
9.	Pump Body	Cast iron
10.	End Plate	Ductile iron or High chrome alloy
11.	Filter	Steel
12.	Oil Seal Bracket	/
13.	Mechanical Seal	Sic-sic/ Sic-sic
14.	Motor Body	Cast iron
15.	Upper Cover	Cast iron
16.	Motor Protector	/
17.	Hose Coupling	Cast iron

Model	Motor Power		Outlet mm	Impeller Passage mm	Max. Head M	Max. Capacity		N.W. Kg	G.W. Kg	Packing Size cm
	KW	HP				m³/min	m³/h			
KBZ21.5	1.5	2	50	8.5	22.0	0.45	27.0	34.5	37.5	59x28x25
KBZ22.2	2.2	3	50	8.5	26.0	0.45	27.0	36	39	59x28x25
KBZ23.7	3.7	5	50	8.5	34.0	0.48	29.0	60	65	68x32x28
KBZ31.5	1.5	2	80	8.5	14.5	0.67	40.0	34.5	37	59x28x25
KBZ32.2	2.2	3	80	8.5	21.0	0.83	50.0	36	39	59x28x25
KBZ33.7	3.7	5	80	8.5	29.0	0.92	55.0	60	65	68x32x28
KBZ35.5	5.5	7.5	80	8.5	32.0	1.17	70.0	77	84	73x35x35
KBZ43.7	3.7	5	100	8.5	18.0	1.50	90.0	61	66	68x32x28
KBZ45.5	5.5	7.5	100	8.5	23.0	1.75	105.0	78	85	73x35x35
KBZ47.5	7.5	10	100	11.5	40.0	1.40	84.0	105	114	81x37x40
KBZ411	11	15	100	11.5	48.5	1.44	86.4	130	140	86x42x45
KBZ415	15	20	100	11.5	56.0	1.44	86.4	142	153	89x42x45
KBZ67.5	7.5	10	150	19.5	31.0	2.08	124.8	106	114	84x37x40
KBZ611	11	15	150	19.5	32.0	2.45	147.0	133	143	86x42x45
KBZ615	15	20	150	19.5	40.0	2.60	156.0	145	156	89x42x45